

GENERAL: Stucco on framed walls must have the wall to roof/deck connection flashing to prevent water entry and incidental water must be allowed to weep out. These details accomplish this goal. Alternatives should be discussed with your SMA contractor.

The continuous "Z" bar flashing method allows for re-roofing at a later date without disturbing the stucco wall. The Z bar can be painted to match stucco and is not noticeable

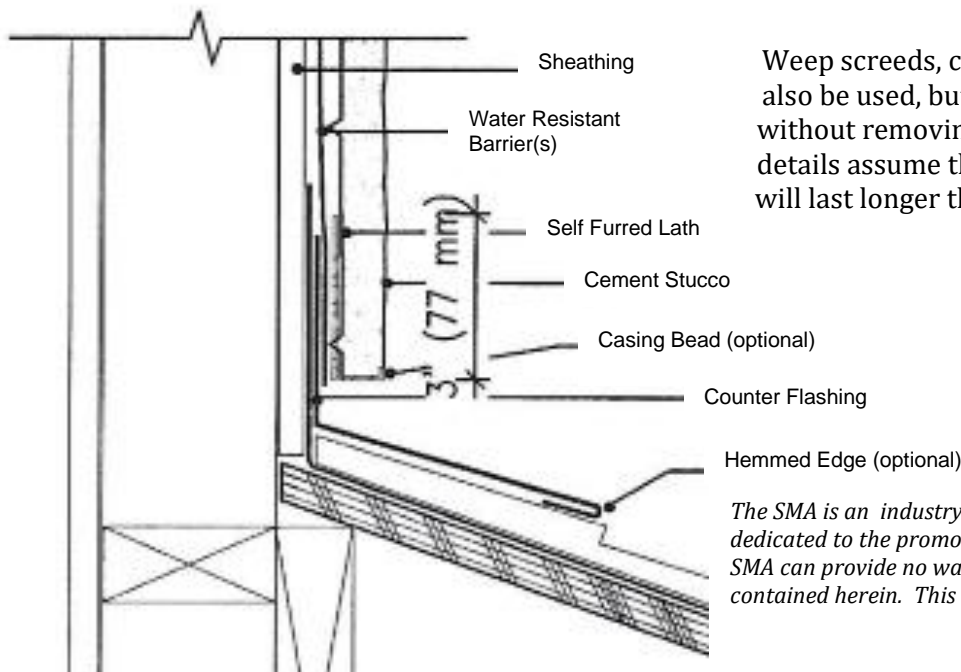
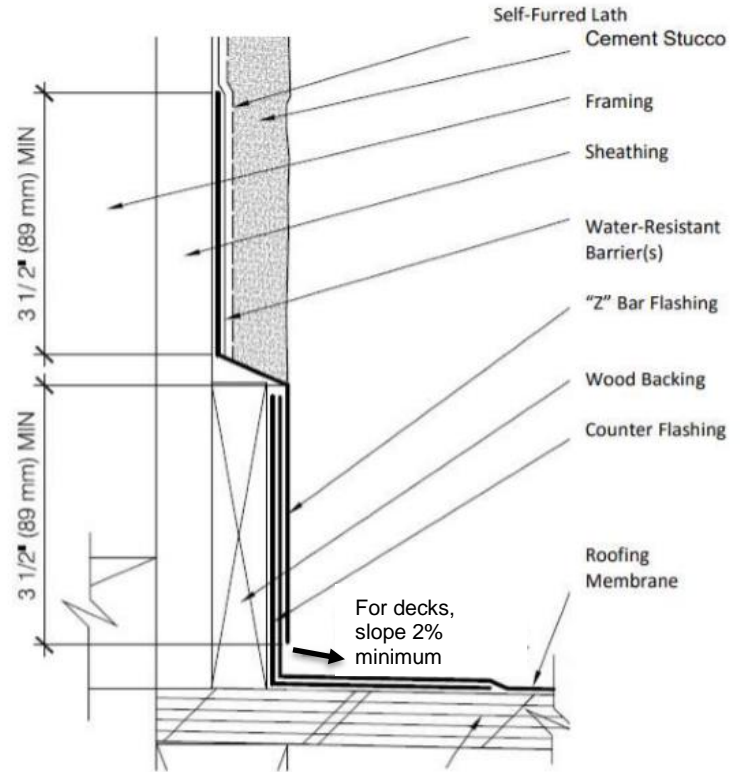

Weep screeds, casing beads and step flashings may also be used, but may not allow for re-roofing without removing of a section of stucco. These details assume the stucco was installed correctly and will last longer than the roofing or decking material.

The SMA is an industry wide not-for-profit trade association dedicated to the promotion and education of the stucco industry. The SMA can provide no warranty, express or implied for information contained herein. This is only a guide paper.