

**GENERAL:** Masonry chimneys are common in homes clad with cement stucco. Code mandates a clearance (varies per jurisdiction) for combustible framing at a masonry chimney. The transition should be flashed in manner to keep water out. The use of a metal edge flashing with an angled lip is one proven, economical option that requires little to no maintenance for home owners.

**INSTALLATION:** The Edge Flashing is set in a bed of approved mastic that adheres to the masonry chimney. The flashing leg is attached to the wood framing. Flashing should over lap the flange of the weepscreed at the foundation. A casing bead with a sealant joint are not required. The water-resistant barrier/lath laps over the flashing leg. Incidental water will travel down the inside corner of the flashing and exit at the base of the wall. This is a time-tested and proven detail used with cement stucco for several decades.

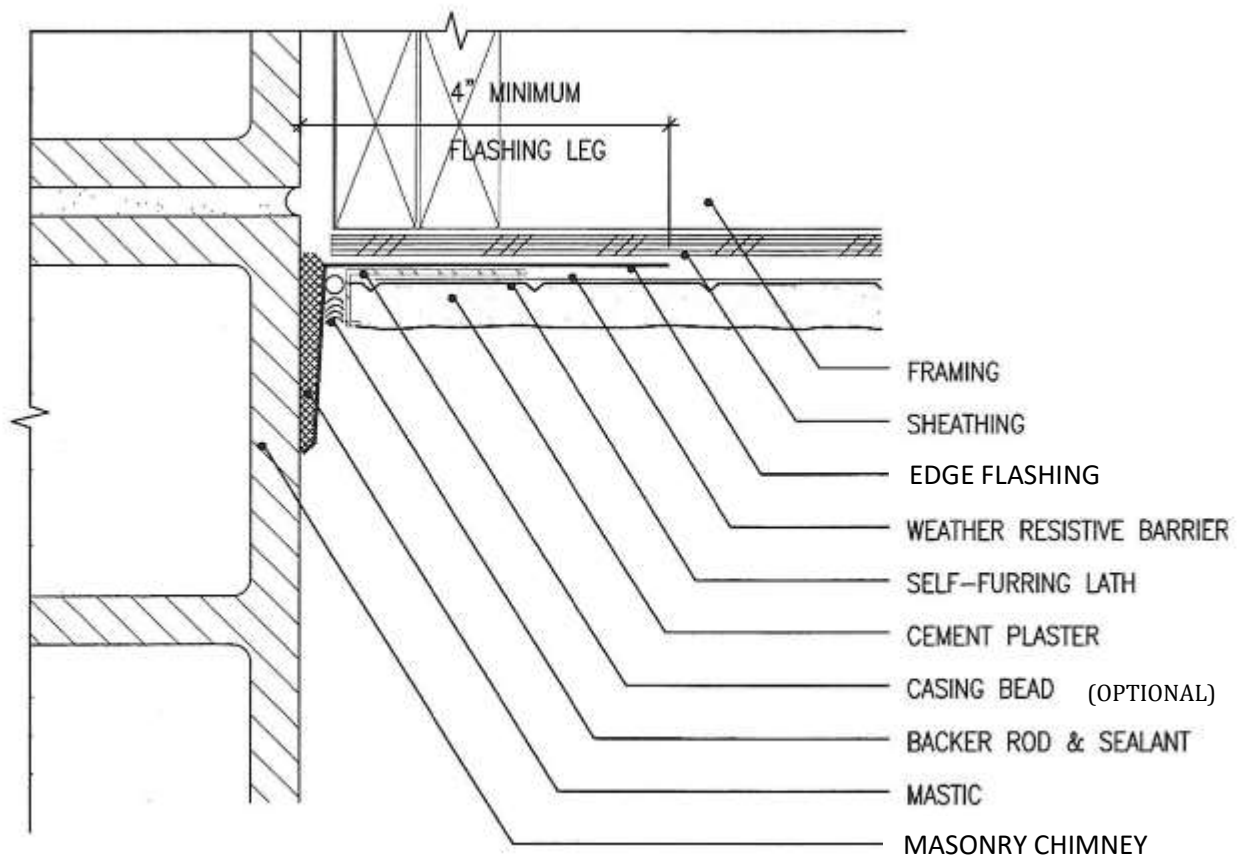

*The SMA is an industry wide not-for-profit trade association dedicated to the promotion and education for the stucco industry. Due to site & design variables, the SMA can provide no warranty, express or implied for information contained herein. This is only a design-guide paper. Verify combustible framing clearance with local code authority.*