

**GENERAL:** The application of cement plaster (stucco) over open stud construction is not prohibited by the building code. It was even a popular method of lathing prior to 2000. The 18 gauge galvanized line wire secured with 4d blued nails provided a backing for the asphalt saturated kraft paper. The wire comes in rolls, traditionally called “stones”. The practice of line wire backing has essentially been replaced by the predominant use of sheathings. This paper will cover how to install the “line wire” as a backing for three-coat stucco in lieu of a sheathing as a backing for stucco.

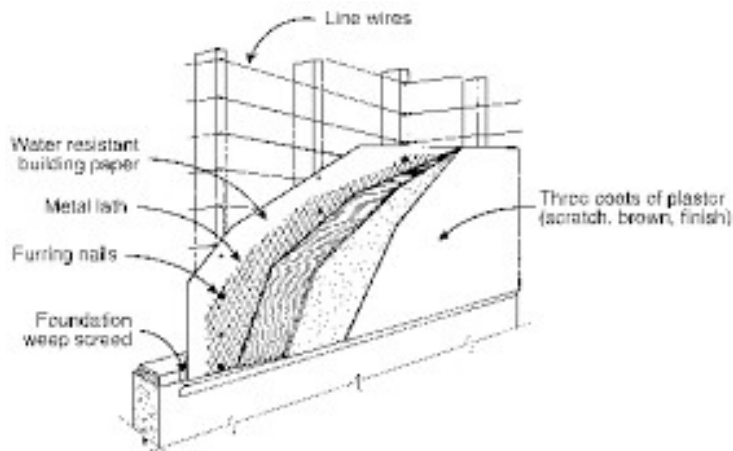

**NAILING:** Starting at the corner stud, space the 4d nails about 8 inches o.c. Only drive nails half-way in. Skip two studs and repeat the process. Skip two more studs and repeat the process again. The last row is the last corner stud.

**LINE WIRE:** Starting on the lowest corner point, wrap the galvanized line wire securely around the nail shank. Run the line wire horizontally to the next lowest nail and loop once around the nail shank and continue this process to end of wall. At the end, run the wire up to the next level and reverse direction looping around the shaft of nails on every fourth stud. Repeat until wall is finished. Cut the wire and drive all nails home. The line wire will now be too loose for an adequate backing. Move to the first stud with no nails, lift the line wire using the shaft of the nail until wire is semi-taught. Drive the nail home. Repeat this process up that stud. Skip to next stud and now push the wire down with the shaft of the nail to make line wire more taught. Drive the nail home. Repeat up the stud. Continue down the wall repeating this process. The horizontal line wire will zig zag slightly up and down the wall. Nails can also be place along windows, doors, etc. For narrow vertical areas, a “Z” pattern of line wire is acceptable. The goal is to simply provide backing support for the building paper during the application of cement plaster. Once the wall is scratch coated and sufficiently rigid to accept the brown coat, the line wire becomes irrelevant (ASTM C926-19 section 7.4.1.2.)

*Use an SMA contractor, verify conditions and all materials used. The SMA is an industry wide not-for-profit trade association dedicated to the promotion and education of the stucco industry. The SMA can provide no warranty, express or implied for information contained herein. This is only a guide paper on historical proven practices.*